

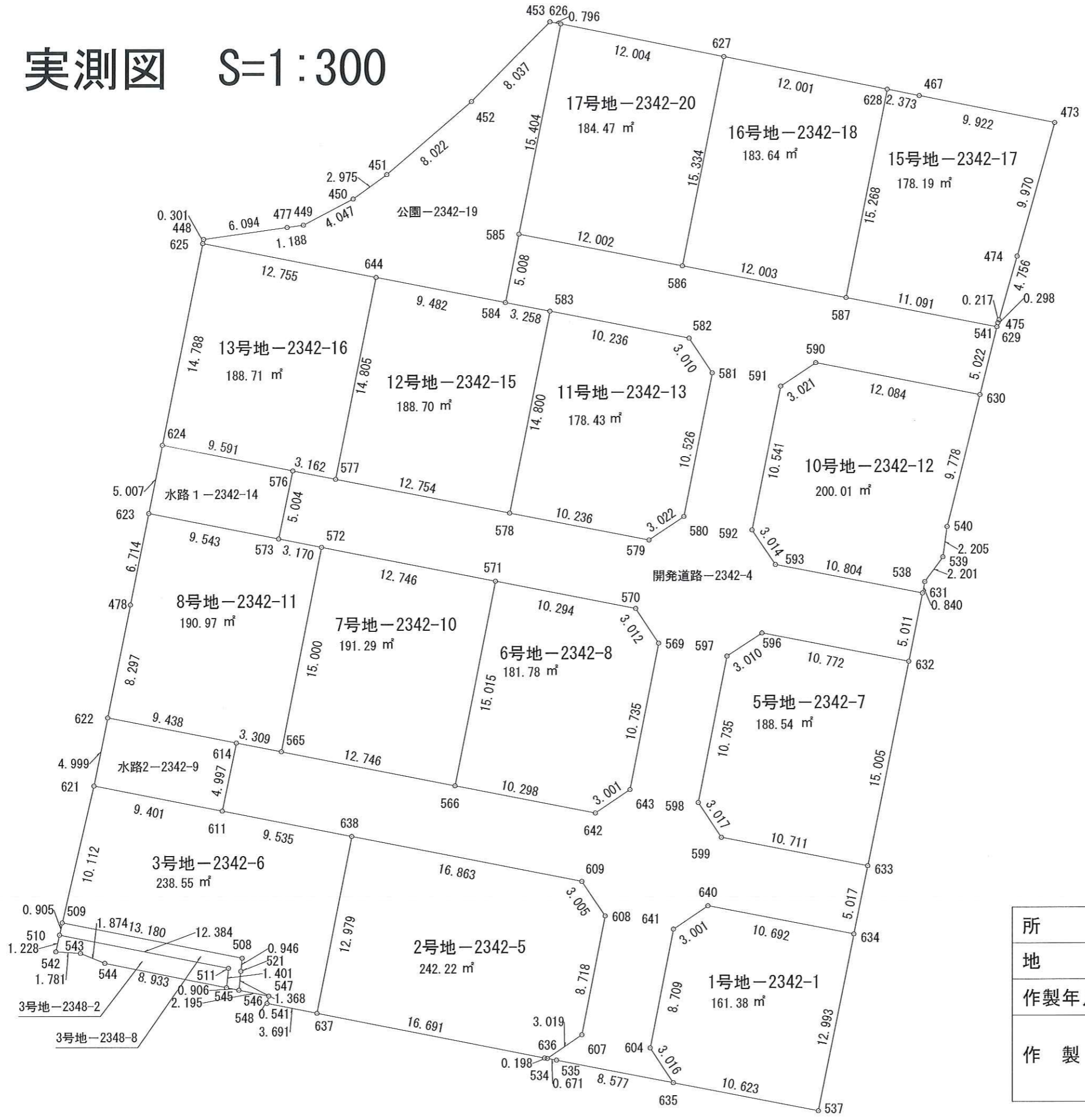

実測図 S=1:300



所在地	高松市香川町大野字中坪
地番	2342-1他
作製年月日	平成30年7月11日
作製者	高松市円座町1580-10 土地家屋調査士 岡野上 竜二 二級建築士 宅地建物取引士



求積表

1号地—2342-1				
NO	Xn	Yn	Yn+1-Yn-1	Xn · (Yn+1-Yn-1)
641	141237.897	48122.166	4.159	587408.413623
640	141239.575	48124.654	12.981	1833430.923075
634	141237.523	48135.147	7.927	1119589.844821
537	141224.786	48132.581	-12.990	-1834509.970140
635	141226.833	48122.157	-12.086	-1706867.503638
604	141229.350	48120.495	0.009	1271.064150
合計				322.771891
合計面積				161.3859455
地積				161.38 m ²

2号地—2342-5				
NO	Xn	Yn	Yn+1-Yn-1	Xn · (Yn+1-Yn-1)
638	141244.618	48099.023	19.055	2691416.195990
609	141241.359	48115.568	18.221	2573558.802339
608	141238.865	48117.244	0.006	847.433190
607	141230.308	48115.574	-4.163	-587941.772204
636	141228.605	48113.081	-2.688	-379622.490240
534	141228.640	48112.886	-16.568	-2339876.107520
637	141231.884	48096.513	-13.863	-1957897.607892
合計				484.453663
合計面積				242.2268315
地積				242.22 m ²

3号地—2342-6				
NO	Xn	Yn	Yn+1-Yn-1	Xn · (Yn+1-Yn-1)
621	141248.274	48080.443	11.495	1623648.909630
611	141246.461	48089.668	18.580	2624359.245380
638	141244.618	48099.023	6.845	966819.410210
637	141231.884	48096.513	-6.131	-865892.680804
548	141232.602	48092.892	-3.494	-493466.711388
547	141233.128	48093.019	-2.025	-285997.084200
546	141233.562	48090.867	-2.013	-284303.160306
521	141234.923	48091.006	0.236	33331.441828
508	141235.864	48091.103	-12.833	-1812479.842712
509	141238.420	48078.173	-10.660	-1505601.557200
合計				417.970438
合計面積				208.9852190
地積				208.98 m ²

3号地—2348-8				
NO	Xn	Yn	Yn+1-Yn-1	Xn · (Yn+1-Yn-1)
509	141238.420	48078.173	-13.130	-1854460.454600
510	141237.537	48077.973	11.949	1697647.329613
511	141235.135	48090.122	12.006	1695669.030810
545	141233.741	48089.979	0.745	105219.137045
546	141233.562	48090.867	1.027	145046.868174
521	141234.923	48091.006	0.236	33331.441828
508	141235.864	48091.103	-12.833	-1812479.842712
合計				-26.489842
合計面積				13.2449210
地積				13.24 m ²

3号地—2348-2				
NO	Xn	Yn	Yn+1-Yn-1	Xn · (Yn+1-Yn-1)
510	141237.537	48077.973	-12.410	-1752757.834170
542	141236.337	48077.712	1.516	214114.286892
543	141236.221	48079.489	3.510	495739.135710
544	141235.507	48081.222	10.490	1481560.468430
545	141233.741	48089.979	8.900	1256980.294900
511	141235.135	48090.122	-12.006	-1695669.030810
合計				-32.679048
合計面積				16.3395240
地積				16.33 m ²

5号地—2342-7				
NO	Xn	Yn	Yn+1-Yn-1	Xn · (Yn+1-Yn-1)
597	141257.549	48126.019	4.572	645829.514028
596	141259.211	48128.528	13.082	1847952.998302
632	141257.151	48139.101	7.610	1074966.919110
633	141242.441	48136.138	-13.474	-1903100.650034
599	141244.502	48125.627	-12.182	-1720640.523364
598	141247.014	48123.956	0.392	55368.829488
合計				377.087530
合計面積				188.5437650
地積				188.54 m ²

6号地—2342-8				
NO	Xn	Yn	Yn+1-Yn-1	Xn · (Yn+1-Yn-1)
571	141262.983	48109.330	12.996	1835853.727068
570	141261.001	48119.431	11.770	1662641.981770
569	141258.494	48121.100	-0.401	-56644.656094
643	141247.960	48119.030	-4.557	-643666.953720
642	141246.281	48116.543	-12.595	-1778996.909195
566	141248.250	48106.435	-7.213	-1018823.627250
合計				363.562579
合計面積				181.7812895
地積				181.78 m ²

7号地—2342-10				
NO	Xn	Yn	Yn+1-Yn-1	Xn · (Yn+1-Yn-1)
572	141265.442	48096.823	15.399	2175346.541358
571	141262.983	48109.330	9.612	1357819.792596
566	141248.250	48106.435	-15.399	-2175081.801750
565	141250.723	48093.931	-9.612	-1357701.949476
合計				382.582728
合計面積				191.2913640
地積				191.29 m ²

8号地—2342-11				
NO	Xn	Yn	Yn+1-Yn-1	Xn · (Yn+1-Yn-1)
623	141267.899	48084.350	10.663	1506339.607037
573	141266.054	48093.713	12.473	1762011.491542
572	141265.442	48096.823	0.218	30795.866356
565	141250.723	48093.931	-6.140	-867279.439220
614	141251.354	48090.683	-12.508	-1766771.935832
622	141253.176	48081.423	-7.633	-1078185.492408
478	141261.312	48083.050	2.927	413471.860224
合計				381.957699
合計面積				190.9788495
地積				190.97 m ²

10号地—2342-12				
NO	Xn	Yn	Yn+1-Yn-1	Xn · (Yn+1-Yn-1)
591	141276.981	48129.835	4.541	641538.770721
590	141278.665	48132.343	14.366	2029609.301390
630	141276.341	48144.201	9.508	1343255.450228
540	141266.850	48141.851	-2.649	-374215.885650
539	141264.665	48141.552	-1.595	-225317.140675
538	141262.886	48140.256	-1.462	-206526.339332
631	141262.063	48140.090	-10.768	-1521109.894384
593	141264.140	48129.488	-12.288	-1735853.752320
592	141266.638	48127.802	0.347	49019.523386
合計				400.033364
合計面積				200.0166820
地積				200.01 m ²

11号地—2342-13				
NO	Xn	Yn	Yn+1-Yn-1	Xn · (Yn+1-Yn-1)
583	141282.414	48113.200	12.899	1822401.858186
582	141280.451	48123.246	11.719	1655665.605269
581	141277.949	48124.919	-0.348	-49164.726252
580	141267.619	48122.898	-4.526	-639377.243594
579	141265.929	48120.393	-12.551	-1773028.674879
578	141267.892	48110.347	-7.193	-1016139.947156
合計				356.871574
合計面積				178.4357870
地積				178.43 m ²

12号地—2342-15				
NO	Xn	Yn	Yn+1-Yn-1	Xn · (Yn+1-Yn-1)
644	141284.867	48100.699	12.173	1719860.685991
584	141283.045	48110.004	12.501	1766179.345545
583	141282.414	48113.200	0.343	48459.868002
578	141267.892	48110.347	-15.369	-2171146.232148
577	141270.342	48097.831	-9.648	-1362976.259616
合計				377.407774
合計面積				188.7038870
地積				188.70 m ²

13号地—2342-16				
NO	Xn	Yn	Yn+1-Yn-1	Xn · (Yn+1-Yn-1)
625	141287.319	48088.182	15.380	2172998.966220
644	141284.867	48100.699	9.649	1363257.681683
577	141270.342	48097.831	-5.970	-843383.941740
576	141270.954	48094.729	-12.512	-1767582.176448
624	141272.811	48085.319	-6.547	-924913.093617
合計				377.436098
合計面積				188.7180490
地積				188.71 m ²

15号地—2342-17				
NO	Xn	Yn	Yn+1-Yn-1	Xn · (Yn+1-Yn-1)
628	141298.327	48137.458	5.261	743370.498347
467	141297.857	48139.784	12.052	1702921.772564
473	141295.893	48149.510	7.051	996277.341543
474	141286.289	48146.835	-3.951	-558222.127839
475	141281.707	48145.559	-1.355	-191436.712985
541	141281.505	48145.480	-0.151	-21333.507255
629	141281.216	48145.408	-10.957	-1548018.283712
587	141283.344	48134.523	-7.950	-1123202.584800
合計				356.395863
合計面積				178.1979315
地積				178.19 m ²

16号地—2342-18				
NO	Xn	Yn	Yn+1-Yn-1	Xn · (Yn+1-Yn-1)
627	141300.702	48125.694	14.714	2079098.529228
628	141298.327	48137.458	8.829	1247522.929083
587	141283.344	48134.523	-14.714	-2078943.123616
586	141285.654	48122.744	-8.829	-1247411.039166
合計				367.295529
合計面積				183.6477645
地積				183.64 m ²

17号地—2342-20				
NO	Xn	Yn	Yn+1-Yn-1	Xn · (Yn+1-Yn-1)
626	141303.077	48113.927	14.728	2081111.718056
627	141300.702	48125.694	8.817	1245848.289534
586	141285.654	48122.744	-14.728	-2080855.112112
585	141287.960	48110.966	-8.817	-1245735.943320
合計				368.952158
合計面積				184.4760790
地積				184.47 m ²

公園—2342-19				
NO	Xn	Yn	Yn+1-Yn-1	Xn · (Yn+1-Yn-1)
453	141303.235	48113.147	6.419	907025.465465
626	141303.077	48113.927	-2.181	-308182.010937
585	141287.960	48110.966	-3.923	-554272.667080
584	141283.045	48110.004	-10.267	-1450553.023015
644	141284.867	48100.699	-21.822	-3083118.367674
625	141287.319	48088.182	-12.459	-1760298.707421
448	141287.614	48088.240	6.092	860724.144488
477	141288.466	48094.274	7.210	1018689.839860
449	141288.632	48095.450	4.763	672957.754216
450	141290.507	48099.037	5.992	846612.717944
451	141292.258	48101.442	8.471	1196886.717518
452	141297.508	48107.508	11.705	1653887.331140
合計				359.194504
合計面積				179.5972520
地積				179.59 m ²

水路1—2342-14				
NO	Xn	Yn	Yn+1-Yn-1	Xn · (Yn+1-Yn-1)
624	141272.811	48085.319	10.379	1466270.505369
576	141270.954	48094.729	8.394	1185828.387876
573	141266.054	48093.713	-10.379	-1466200.374466
623	141267.899	48084.350	-8.394	-1185802.744206