

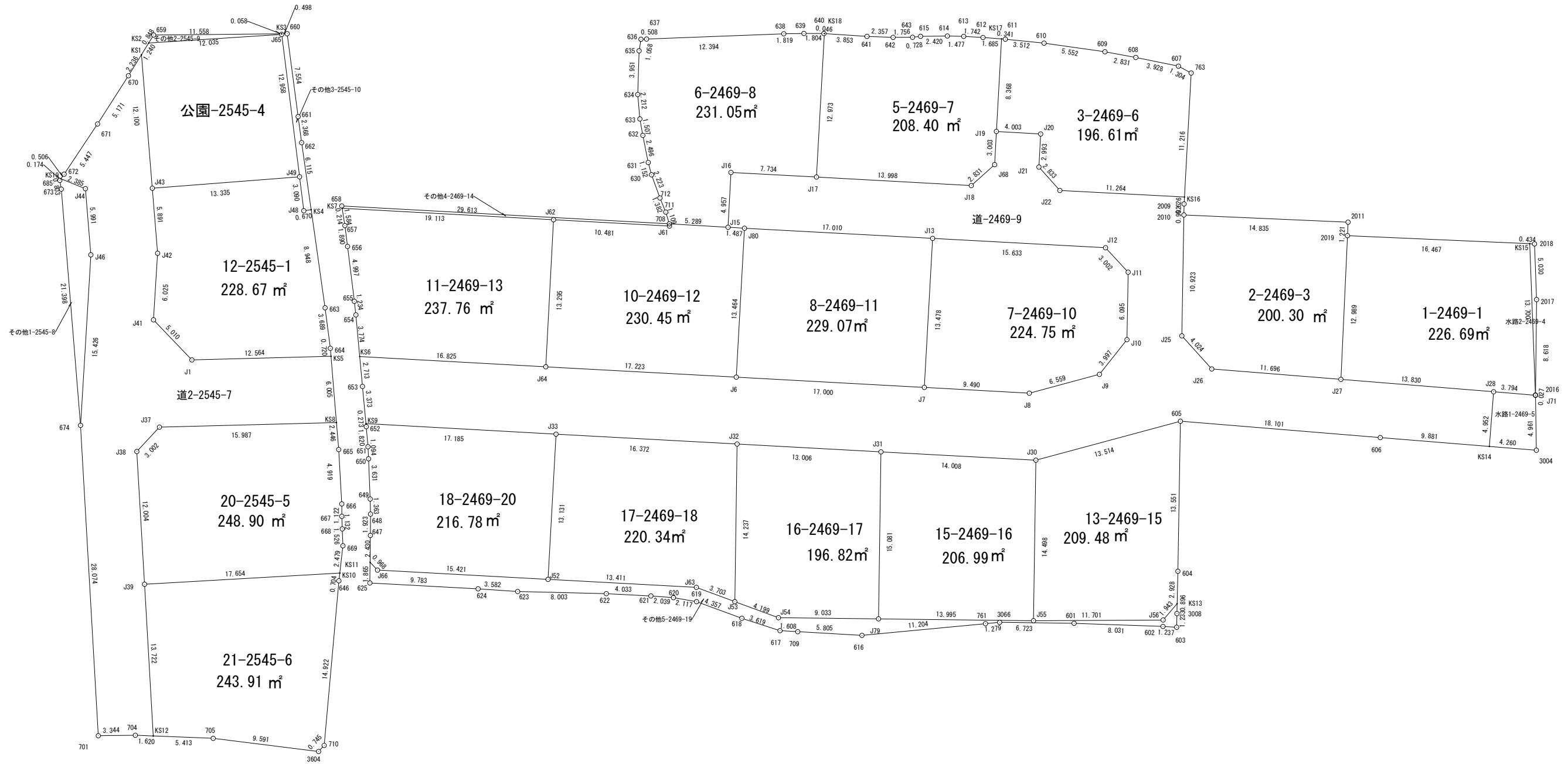

実測図S=1:400



所在	さぬき市志度字花池尻2469-1他
地番	
作製年月日	令和8年3月30日
作製者	高松市仏生山町甲2130-1 土地家屋調査士・二級建築士 岡野上竜二 宅地建物取引士

求積表

地番 A 1-2469-1					
NO	Xn	Yn	Yn+1-Yn-1	Xn・(Yn+1-Yn-1)	
2019	146317.397	61814.942	17.045	2493980.031865	
KS15	146316.673	61831.393	16.971	2483140.257483	
J71	146302.983	61831.913	-3.280	-476947.724580	
J28	146303.304	61828.133	-17.565	-2569817.534760	
J27	146304.422	61814.348	-13.191	-1929901.630602	
合計				453.399406	
合計面積				226.697030	
地積				226.69 m ²	

地番 B 2-2469-3					
NO	Xn	Yn	Yn+1-Yn-1	Xn・(Yn+1-Yn-1)	
2010	146319.270	61800.174	15.003	2195228.007810	
2011	146318.617	61814.995	14.768	2160833.335856	
2019	146317.397	61814.942	-0.647	-94667.355859	
J27	146304.422	61814.348	-12.252	-1792521.778344	
J26	146305.363	61802.690	-14.356	-2100359.791228	
J25	146308.349	61799.992	-2.516	-368111.806084	
合計				400.612151	
合計面積				200.3060755	
地積				200.30 m ²	

地番 C 3-2469-6					
NO	Xn	Yn	Yn+1-Yn-1	Xn・(Yn+1-Yn-1)	
763	146332.087	61800.830	0.544	79604.655328	
KS16	146320.887	61800.224	-11.854	-1734487.794498	
J22	146321.481	61788.976	-13.137	-1922225.295897	
J21	146323.592	61787.087	-1.733	-253578.784936	
J20	146326.581	61787.243	-3.841	-562040.397621	
J19	146326.809	61783.246	-3.527	-516094.655343	
KS17	146335.164	61783.716	0.810	118531.482840	
611	146335.138	61784.056	3.834	561048.919092	
610	146334.780	61787.550	8.991	1315696.006980	
609	146334.001	61793.047	8.282	1211938.196282	
608	146333.491	61795.832	6.633	970630.045803	
607	146332.702	61799.680	4.998	731370.844596	
合計				393.222626	
合計面積				196.6113130	
地積				196.61 m ²	

地番 D 5-2469-7					
NO	Xn	Yn	Yn+1-Yn-1	Xn・(Yn+1-Yn-1)	
J19	146326.809	61783.246	-0.626	-91600.582434	
J68	146323.810	61783.090	-2.264	-331277.105840	
J18	146321.921	61780.982	-16.085	-2353588.099285	
J17	146322.693	61767.005	-13.261	-1940385.231873	
KS18	146335.646	61767.721	4.561	867436.881406	
641	146335.391	61771.566	6.200	907279.424200	
642	146335.304	61773.921	4.111	601584.434744	
643	146335.311	61775.677	2.479	362765.235969	
615	146335.398	61776.400	3.143	459932.155914	
614	146335.426	61778.820	3.897	570269.155122	
613	146335.394	61780.297	3.216	470614.627104	
612	146335.291	61782.036	3.419	500320.359929	
KS17	146335.164	61783.716	1.210	177065.548440	
合計				416.803396	
合計面積				208.4016980	
地積				208.40 m ²	

地番 D 6-2469-8					
NO	Xn	Yn	Yn+1-Yn-1	Xn・(Yn+1-Yn-1)	
636	146335.135	61751.159	0.676	99776.216125	
637	146335.150	61751.667	12.893	1886699.088950	
638	146335.627	61764.052	14.204	2078551.245098	
639	146335.657	61785.871	3.623	530174.085311	
640	146335.649	61767.675	1.850	270720.950650	
KS18	146335.646	61767.721	-0.670	-98044.882820	
J17	146322.693	61767.005	-8.439	-1234817.206227	
J16	146323.108	61759.282	-7.983	-1168097.371164	
J15	146318.158	61759.022	-5.563	-813967.912954	
708	146318.465	61753.719	-5.626	-823187.684090	
711	146319.526	61753.396	-0.846	-123786.318996	
712	146320.805	61752.873	-1.284	-187876.913620	
630	146322.894	61752.112	-1.059	-154965.944746	
631	146324.007	61751.814	-0.784	-114718.021488	
632	146326.465	61751.328	-0.752	-110037.494160	
633	146327.938	61751.062	-0.462	-67603.607356	
634	146330.141	61750.856	-0.070	-10243.109870	
635	146334.090	61750.992	0.293	42876.888370	
合計				462.107823	
合計面積				231.0539115	
地積				231.05 m ²	

地番 F 7-2469-10					
NO	Xn	Yn	Yn+1-Yn-1	Xn・(Yn+1-Yn-1)	
J13	146317.153	61777.491	16.261	2393894.940233	
J12	146316.306	61793.101	17.649	2582336.484594	
J11	146314.103	61795.140	1.935	283117.789305	
J10	146308.009	61795.036	-2.590	-378937.743310	
J9	146304.879	61792.550	-8.820	-1290409.032780	
J8	146303.174	61786.216	-15.810	-2313053.180940	
J7	146303.696	61776.740	-8.725	-1276499.747600	
合計				449.509502	
合計面積				224.7547510	
地積				224.75 m ²	

地番 B 8-2469-11					
NO	Xn	Yn	Yn+1-Yn-1	Xn・(Yn+1-Yn-1)	
J80	146318.067	61760.506	17.726	2593634.055642	
J13	146317.153	61777.491	16.234	2375312.661802	
J7	146303.696	61776.740	-17.726	-2583379.315296	
J6	146304.623	61759.765	-16.234	-2375109.249782	
合計				458.152386	
合計面積				229.0761830	
地積				229.07 m ²	

地番 H 10-2469-12					
NO	Xn	Yn	Yn+1-Yn-1	Xn・(Yn+1-Yn-1)	
J62	146318.834	61743.268	11.167	1633942.419278	
J61	146318.266	61753.734	10.451	1529172.197966	
708	146318.465	61753.719	5.288	773732.042920	
J15	146318.158	61759.022	6.787	993061.338346	
J80	146318.067	61760.506	0.743	108714.323781	
J6	146304.623	61759.765	-17.939	-2624568.631997	
J64	146305.557	61742.567	-16.497	-2413602.773829	
合計				460.916465	
合計面積				230.4582325	
地積				230.45 m ²	

地番 I 11-2469-13					
NO	Xn	Yn	Yn+1-Yn-1	Xn・(Yn+1-Yn-1)	
J62	146318.834	61743.268	18.384	2689925.444256	
J64	146305.557	61742.567	-17.500	-2560347.247500	
KS6	146306.486	61725.768	-17.143	-2508132.089498	
654	146310.244	61725.424	-0.485	-70960.468340	
655	146311.470	61725.283	-0.754	-110318.848380	
656	146316.429	61724.670	-0.852	-124661.597508	
657	146318.304	61724.431	-0.487	-71257.014048	
KS7	146319.868	61724.183	18.837	2756227.353516	
合計				475.532498	
合計面積				237.7662490	
地積				237.76 m ²	

地番 J 12-2545-1					
NO	Xn	Yn	Yn+1-Yn-1	Xn・(Yn+1-Yn-1)	
J43	146321.680	61707.044	12.816	1875258.650880	
J49	146322.714	61720.339	13.676	2001109.436664	
J48	146319.648	61720.720	1.044	152757.712512	
KS4	146319.744	61721.383	1.921	281080.228224	
663	146310.885	61722.641	1.734	253703.074590	
664	146307.227	61723.117	0.535	78274.366445	
KS5	146306.509	61723.176	-12.501	-1828977.689009	
J1	146306.176	61710.616	-16.025	-2344556.470400	
J41	146309.795	61707.151	-3.093	-452536.195935	
J42	146315.809	61707.523	-0.107	-15655.791563	
合計				457.342408	
合計面積				228.6712040	
地積				228.67 m ²	

地番 K 13-2469-15					
NO	Xn	Yn	Yn+1-Yn-1	Xn・(Yn+1-Yn-1)	
J30	146297.125	61786.812	13.262	1840192.471750	
605	146300.644	61799.860	12.819	1875427.955436	
604	146297.095	61799.631	-0.296	-43300.980120	
KS13	146284.168	61799.564	-1.332	-194850.511776	
J56	146282.693	61798.299	-12.966	-1896701.397438	
J55	146282.629	61786.598	-11.487	-1680348.559323	
合計				418.978529	
合計面積				208.4892645	
地積				209.48 m ²	

地番 L 15-2469-16					
NO	Xn	Yn	Yn+1-Yn-1	Xn・(Yn+1-Yn-1)	
J30	146297.125	61786.812	13.774	2015096.599750	
J55	146282.629	61786.598	-14.208	-2078383.592832	
J79	146282.795	61772.604	-13.774	-2014899.218330	
J31	146297.874	61772.824	14.208	2078600.193792	
合計				413.982380	
合計面積				206.9911900	
地積				206.99 m ²	

地番 M 16-2469-17					
NO	Xn	Yn	Yn+1-Yn-1	Xn・(Yn+1-Yn-1)	
J31	146297.874	61772.824	12.766	1867638.659484	
J79	146282.795	61772.604	-9.252	-1353408.419340	
J54	146282.901	61763.572	-12.972	-1897581.791772	
J53	146284.352	61759.632	-3.734	-546225.770368	
J32	146298.588	61759.838	13.192	1929970.972896	
合計				393.650900	
合計面積				196.8254500	
地積				196.82 m ²	

地番 N 17-2469-18					
NO	Xn	Yn	Yn+1-Yn-1	Xn・(Yn+1-Yn-1)	
J33	146299.476	61743.490	17.068	2497039.456368	
J32	146298.588	61759.838	16.142	2361551.807496	
J53	146284.352	61759.632	-3.677	-537887.562304	
J63	146285.641	61756.161	-16.862	-2466668.478542	
J52</					

Z その他4-2469-14				
地番	Xn	Yn	Yn+1-Yn-1	Xn · (Yn+1-Yn-1)
NO				
658	146320.079	61724.150	29.536	4321709.853344
708	146318.465	61753.719	29.584	4328685.468560
J61	146318.266	61753.734	-10.451	-1529172.197966
J62	146318.834	61743.268	-29.551	-4323867.863534
KS7	146319.868	61724.183	-19.118	-2797343.236424
			合計	12.023980
			合計面積	6.0119900
			地積	6.01 m ²

A' その他5-2469-19				
地番	Xn	Yn	Yn+1-Yn-1	Xn · (Yn+1-Yn-1)
NO				
625	146286.039	61726.686	-9.749	-1426142.594211
KS11	146287.904	61726.706	0.686	100353.502144
J66	146287.202	61727.372	16.064	2349957.612928
J52	146286.365	61742.770	28.789	4211438.161985
J63	146285.641	61756.161	16.862	2466668.478542
J53	146284.352	61759.632	7.411	1084113.332672
J54	146282.901	61763.572	12.972	1897581.791772
J79	146282.795	61772.604	23.026	3368307.637670
J55	146282.629	61786.598	25.695	3758732.152155
J56	146282.693	61798.299	12.966	1896701.397438
KS13	146284.168	61799.564	1.245	182123.789160
3008	146283.272	61799.544	-0.044	-6436.463968
603	146282.039	61799.520	-1.259	-184169.087101
602	146282.113	61798.285	-9.261	-1354718.648493
601	146282.395	61790.259	-14.748	-2157372.761460
3066	146282.486	61783.537	-7.995	-1168528.475570
761	146282.365	61782.264	-12.427	-1817850.849855
616	146281.304	61771.110	-16.949	-2479321.821496
709	146281.639	61765.315	-7.400	-1082484.128600
617	146281.732	61763.710	-5.048	-738430.183136
618	146282.848	61760.267	-7.533	-1101948.693984
619	146284.349	61756.177	-6.176	-903452.139424
620	146284.712	61754.091	-4.119	-602546.728728
621	146284.867	61752.058	-6.061	-886632.578887
622	146285.073	61748.030	-12.029	-1758663.143117
623	146285.266	61740.029	-11.575	-1693251.853950
624	146285.508	61736.455	-13.343	-1951887.633244
			合計	139.971242
			合計面積	69.9856210
			地積	69.98 m ²